

Estes Park Medical Center First Floor Map

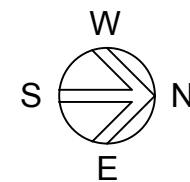

- ① Take main entrance to public elevator (or lobby stairs) to second floor. Outpatient registration is first desk at top of the stairs and second floor exit from elevator.
- ② Take main entrance to public elevator (or lobby stairs) to second floor. Turn right and follow corridor above lobby through double doors to the Inpatient Unit Nurses' Station
- ③ Take main entrance to public elevator (or lobby stairs) to second floor. Turn right and follow corridor above lobby through double doors to the Inpatient Unit Nurses' Station.

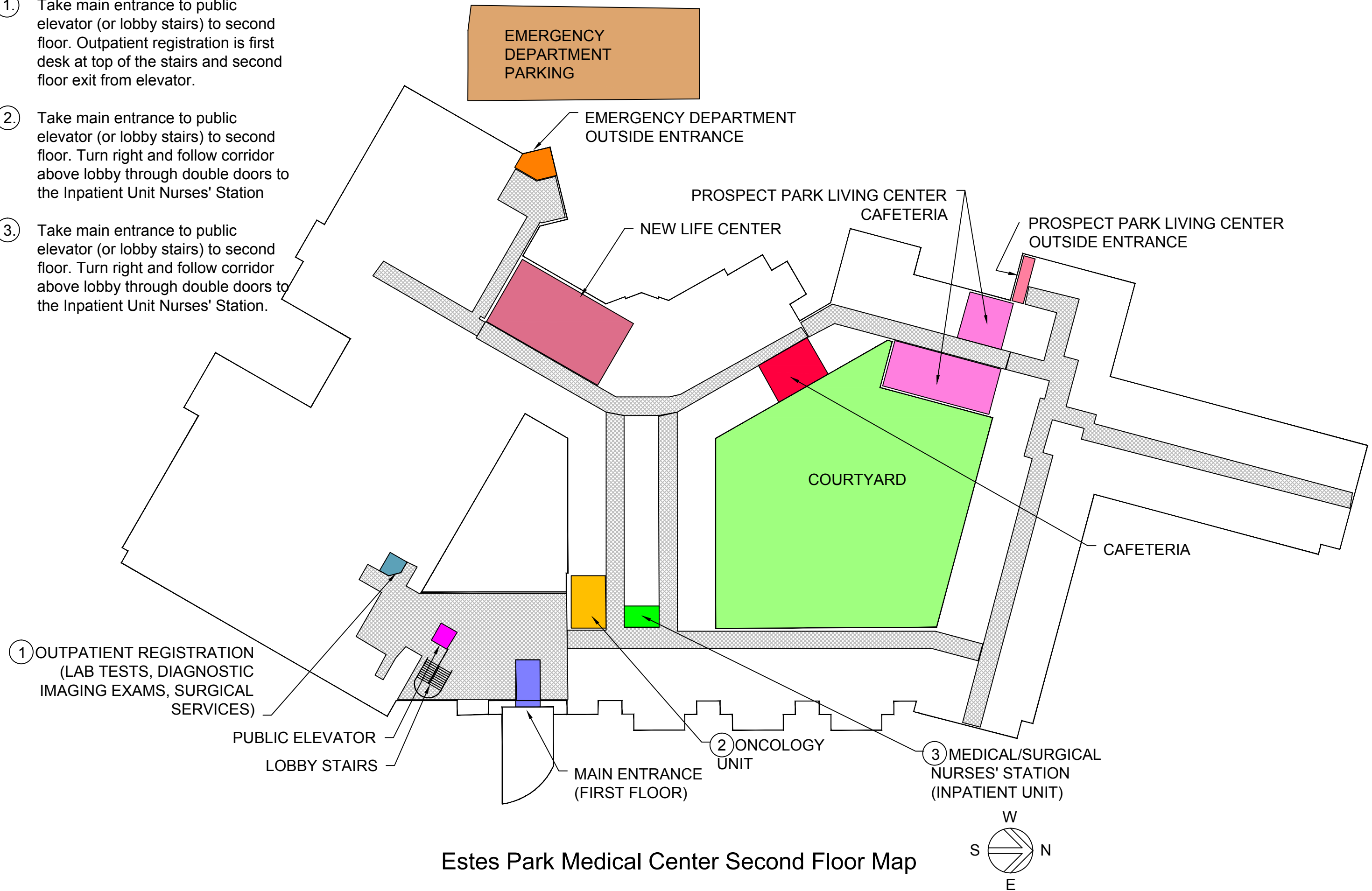

Estes Park Medical Center Second Floor Map